

~ STUDIO 75 ~

7520 Burlington St. Omaha, NE 68127 (402) 331-4340

STAGE:

Dimensions: 28' x 40' (1120 sq. ft.)
15'6" Clear Height to Grid
* 24' x 40' x 15' High 2-Walled Hard Cyc
Features: 4 Ton Air Conditioning System
** 750 Amps Electrical Service (250Amp 3 Phase)
Sound Baffled

INCLUDES:

20' x 20' Kitchenette/Breakroom (400 sq. ft.)
10' x 12' Make Up/Wardrobe Room (120 sq. ft.)
Ample Parking

PRODUCTION OFFICE (\$100.00 per day):

Dimensions: 12' x 16' (192 sq. ft.)

Features: Tables & Chairs
Wireless Internet
Air Conditioned
Dry Erase Board

RATES:

Basic Day 8:00 Am to 6:00 PM	
Prep or Strike	\$500.00 Per Day
Pre-Light or Shoot	\$650.00 Per Day
1/2 Day (5 hours)	\$450.00 Per Day
Hourly Rate	\$100.00 Per Hour
Overtime	\$80.00 Per Hour
Weekends	\$100.00 Add'l Daily
Weekend Overtime	\$125.00 Per Hour
Power: Pre-Light or Shoot	\$200.00 Per Day
** Studio Lighting Package	\$350.00 Per Day

Stage rates include a houseman present at all times at no additional charge.

Total rental time includes unloading, setup, strike, shoot, cleanup & loading.

* Cyc is furnished pure white or green and must be in same condition at end of rental.

** Power is included at no charge if Lights On Nebraska supplies lighting & grip equipment.

STUDIO 75

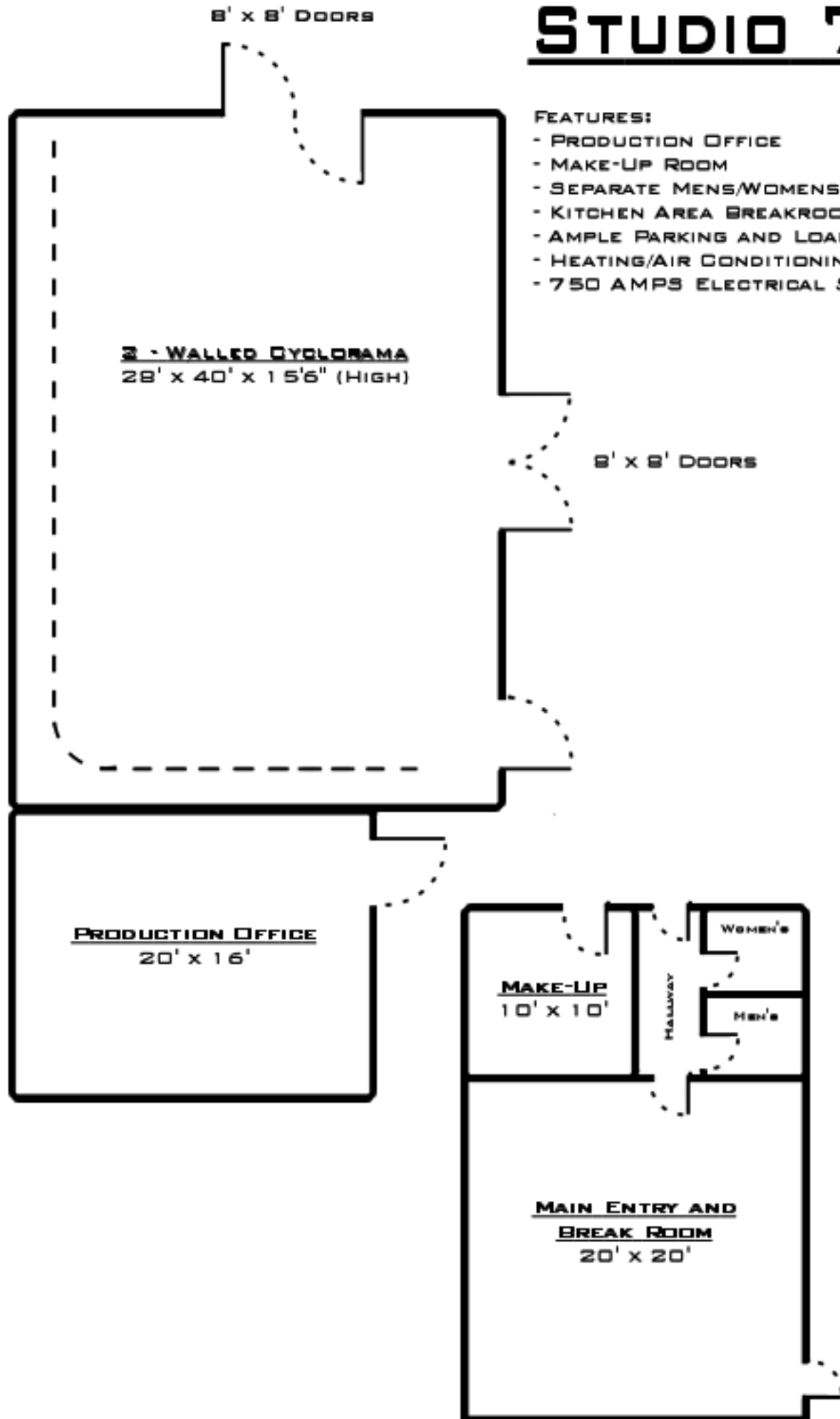

FEATURES:

- PRODUCTION OFFICE
- MAKE-UP ROOM
- SEPARATE MENS/WOMENS FACILITIES
- KITCHEN AREA BREAKROOM
- AMPLE PARKING AND LOADING AREAS
- HEATING/AIR CONDITIONING
- 750 AMPS ELECTRICAL SERVICE

~ STUDIO 75 ~

Basic Equipment:

(No charge with studio rental)

12' rolling ladder, garment rack, 3-director's chairs.

Notes:

- 1) Props are the responsibility of the production company. Lights On Nebraska charges a one time fee to store or discard props.
- 2) Renter is responsible for damage to and/or loss of any and all basic equipment ("Studio Essentials"), props, and extras present in the studio.

Extra Equipment:

Equipment Rental (see attached list)

Cyc Painting:

Paint In: Cyc cannot be painted during a scheduling conflict. Call to confirm availability. Weekend painting hours are available at an additional charge.

Paint Out: Cyc must be returned to original color (White) after use in any other color. Client may handle "Paint In", but Studio 75, must handle Paint Out. If client handles "Paint In", painting must be done during rented studio time.

Cyc Dimensions:	40' wide x 15'6" high x 24' deep
Cyc Painting Studio Rental:	\$20 per hour
Painting Labor:	\$30 per hour (minimum 1 hr)
Fresh White Cyc Floor:	\$90 (2 Gallon White: \$60, 1hr. Labor: \$30)
Paint In, Ultimate Green/Blue:	\$90/Gallon + Labor
Paint In, Standard colors:	\$30/Gallon + Labor
Paint Out White (from colors):	\$200.00 Flat Fee

Studio Policies / Rental Terms:

We intend to help make your production go as smoothly as possible by providing friendly service. We understand that things change very rapidly, especially in this business. That's why we provide the flexibility to guarantee both a pleasant and successful visit. However, at the same time, we want to be professional. We have written a few policies that will help insure a respectful working relationship.

~ STUDIO 75 ~ RENTAL CONTRACT ~ TERMS & CONDITIONS ~

Reserving the Studio:

Use of the Studio is by reservation only. There are two ways to reserve time in the studio. A "HOLD" will set aside time with no obligation. A "BOOKED" status reserves time exclusively.

If Studio 75/Lights On Nebraska receives a request to BOOK time that is on HOLD by another client, that client has 24 hours to either BOOK or release that time. If the client chooses to BOOK the time, the client is responsible for the full Rental Rate, even if canceled.

All reservations require two items in advance:

- Signed Rental Agreement
- Certificate of General Liability Insurance listing Lights On Nebraska, 7520 Burlington St., as Additional Insured and Loss Payee.

Insurance:

Proof thereof must be faxed prior to booking. Lessee agrees to indemnify and hold Lights On Nebraska/Studio 75 harmless from any and all claims, costs, expenses, damages and liabilities, including attorney's fees, arising out of lessee's use or possession of the equipment/facility.

Wrap Policies:

Studio and common area rooms are to be left cleared of any debris or set pieces. A quick sweep of the studio is necessary to return the space to its pre-shoot condition. Additional cleanup will result in additional charges. Damage/Lost or missing property will be billed accordingly. Additional disposal services will be quoted as necessary.

Other Policies:

- 1) Please report any damage immediately to the studio manager. All damage loss or repair will be billed accordingly.
- 2) At end of booking, trash must be in dumpster and floor must be swept. Bathroom and other common areas used during rental must be left in same condition as beginning rental.
- 3) No smoking for personal use in studio building. Outside the building is permitted.
- 4) No equipment or props may leave the studio at any time. The Renter of the studio is responsible for any damage or loss incurred during rental period.
- 5) Renter may not leave studio unattended. If Renter must leave the premises, a manager or agent of Lights On Nebraska/Studio 75 must be called in to attend the studio before the Renter can leave. In that case, Lights On Nebraska Studio 75, or its agent may lock up the studio until the Renter returns.
- 6) All other areas and upper levels are off limits to all renters or guests.
- 7) No climbing of ladders to storage areas by renters or guests without approval from Lights On Nebraska/Studio 75 or studio managers.
- 8) Parking is available in parking lot during business hours or during paid overtime hours.

Signature: _____ **Date:** _____

Agent of: _____

STUDIO LIGHTING PACKAGE (Tungsten) \$350.00

- 4) 2,000W 8" Junior Solarspots (2-Snoot Sets)
- 4) 1,000W Baby Solarspots (2-Snoot Sets)
- 4) 650W Tweenie Solarspots (2-Snoot Sets)
- 4) 200W Midget Solarspots (2-Snoot Sets)
- 2) 2,000W Mighty Moles
- 1) 2,000W Baby Soft Lights
- 1) 750W Soft Lights

STANDS

- 2 3 Riser Combo Stands (Max. Ht. 14'3")
- 7 2 Riser Combo Stands (Max. Ht. 11'3")
- 2 Low Boy Combo Stands (Min. Ht. 33")
- 8 Beefy Baby Stands (Max. Ht. 12'5")
- 2 Mini Baby Stands (Min. Ht. 22")
- 1 Floor Spider (T-Bone)

C-STANDS & FLAGS

- 10 40" C-Stands W/Heads & Arms
- 2 20" C-Stands W/Heads & Arms
- 1 Set Fingers 2" x 14", 4" x 14", 6" x 14" (9 pcs.)
- 1 Set Fingers 2" x 14", 4" x 14", 6" x 14" (9 pcs.)
- 4 18" x 24" flags
- 2 18" x 24" Silks
- 2 18" X 24" Single Nets
- 2 18" x 24" Double Nets
- 2 24" x 36" Flags
- 2 24" x 36" Silks
- 2 24" x 36" Single Nets
- 2 24" x 36" Double Nets
- 2 48" x 48" Flags (Flop Down)
- 2 24" x 36" Open Frames
- 4 48" x 48" Open Frames
- 1 C Stand/Flag Cart

GRIP EQUIPMENT

- 12 Shot Bags (15 lb)
- 16 Apple Boxes (4 ea.)
 - 2 Fiberglass Step Ladders (6' & 12')
 - 2 10' Speedrail Pipe (1-1/4")
 - 2 5' Speedrail Pipe (1-1/4")
 - 3 Pipe Joiners (1-1/4")
- 10 Safety Cables/Chains
- 16 # 1 Grip Clips
- 12 # 2 Grip Clips
- 6 # 3 Grip Clips
- 1 Set Wedges (24)
- 1 Set Cribbing (24)
- 6 Furniture/Sound Blankets

JUNIOR GRIP

- 4 Large Jr. Grip Heads (4-1/2")
- 1 Jr. Triple Headers
- 6 Jr. Pipe Hangers
- 4 Jr. Wall Plates
- 2 C ClampsW/Jr. Receiver
- 4 Stand Adapters (1-1/8" to 5/8")
- 4 Jr. Pipe Palms
- 1 Jr. C Stand Boom Clamp

BABY SIZE GRIP

- 1 Baby Triple Header
- 4 Baby Wall Plates
- 8 Baby Pipe Hangers
- 4 C-Clamps W/Baby Spud
- 4 Gator Grips W/Baby Spud
- 2 Mafer Clamps W/Baby Spud
- 4 Cardellini Clamps W/Baby Spud
- 2 Bead Board Holders
- 1 Cantrell Holder

SUPPORT

- 1 12' x 12' Overhead Set
Includes: 1-Frame, 1-Silk, 1-Solid, 1-Griff
- 1 6' x 6' Overhead Set
Includes: 1-Frame, 1-Silk, 1-Solid, 1-Griff

ELECTRICAL

- 1 600 Amp Matthews Single-Phase Camlok Thru Box
- 2 50' 100 Amp Bates Extension Cables
- 2 25' 100 Amp Bates Extension Cables
- 2 50' 60 Amp Bates Extension Cables
- 2 25' 60 Amp Bates Extension Cables
- 3 100 Amp Bates to 2-60 Amp Female Bates
- 2 100 Amp Bates to 5-20A Edisons (Circuit Breaker)
- 2 60A Bates to 3-20A Duplex Edisons (Circuit Breaker)
- 12 25' A/C Edison Extensions (12/3 Cable)
- 6 50' A/C Edison Extensions (12/3 Cable)
- 6 Edison Cube Taps
- 1 1,000W Dimmer
- 1 2,000W Dimmer

STUDIO GRIP/ELECTRIC/SUPPORT PKG. \$225.00

STANDS

- 2 3 Riser Combo Stands (Max. Ht. 14'3")
- 7 2 Riser Combo Stands (Max. Ht. 11'3")
- 2 Low Boy Combo Stands (Min. Ht. 33")
- 8 Beefy Baby Stands (Max. Ht. 12'5")
- 2 Mini Baby Stands (Min. Ht. 22")
- 1 Floor Spider (T-Bone)

C-STANDS & FLAGS

- 10 40" C-Stands W/Heads & Arms
- 2 20" C-Stands W/Heads & Arms
- 1 Set Fingers 2" x 14", 4" x 14", 6" x 14" (9 pcs.)
- 1 Set Fingers 2" x 14", 4" x 14", 6" x 14" (9 pcs.)
- 4 18" x 24" flags
- 2 18" x 24" Silks
- 2 18" X 24" Single Nets
- 2 18" x 24" Double Nets
- 2 24" x 36" Flags
- 2 24" x 36" Silks
- 2 24" x 36" Single Nets
- 2 24" x 36" Double Nets
- 2 48" x 48" Flags (Flop Down)
- 2 24" x 36" Open Frames
- 4 48" x 48" Open Frames
- 1 C Stand/Flag Cart

GRIP EQUIPMENT

- 12 Shot Bags (15 lb)
- 16 Apple Boxes (4 ea.)
- 2 Fiberglass Step Ladders (6' & 12')
- 2 10' Speedrail Pipe (1-1/4")
- 2 5' Speedrail Pipe (1-1/4")
- 3 Pipe Joiners (1-1/4")
- 10 Safety Cables/Chains
- 16 # 1 Grip Clips
- 12 # 2 Grip Clips
- 6 # 3 Grip Clips
- 1 Set Wedges (24)
- 1 Set Cribbing (24)
- 6 Furniture/Sound Blankets

JUNIOR GRIP

- 4 Large Jr. Grip Heads (4-1/2")
- 1 Jr. Triple Headers
- 6 Jr. Pipe Hangers
- 4 Jr. Wall Plates
- 2 C Clamps W/Jr. Receiver
- 4 Stand Adapters (1-1/8" to 5/8")
- 4 Jr. Pipe Palms
- 1 Jr. C Stand Boom Clamp

BABY SIZE GRIP

- 1 Baby Triple Header
- 4 Baby Wall Plates
- 8 Baby Pipe Hangers
- 4 C-Clamps W/Baby Spud
- 4 Gator Grips W/Baby Spud
- 2 Mafer Clamps W/Baby Spud
- 4 Cardellini Clamps W/Baby Spud
- 2 Bead Board Holders
- 1 Cantrell Holder

SUPPORT

- 1 12' x 12' Overhead Set
Includes: 1-Frame, 1-Silk, 1-Solid, 1-Griff
- 1 6' x 6' Overhead Set
Includes: 1-Frame, 1-Silk, 1-Solid, 1-Griff

ELECTRICAL

- 1 600 Amp Matthews Single-Phase Camlok Thru Box
- 2 50' 100 Amp Bates Extension Cables
- 2 25' 100 Amp Bates Extension Cables
- 2 50' 60 Amp Bates Extension Cables
- 2 25' 60 Amp Bates Extension Cables
- 3 100 Amp Bates to 2-60 Amp Female Bates
- 2 100 Amp Bates to 5-20A Edisons (Circuit Breaker)
- 2 60A Bates to 3-20A Duplex Edisons (Circuit Breaker)
- 12 25' A/C Edison Extensions (12/3 Cable)
- 6 50' A/C Edison Extensions (12/3 Cable)
- 6 Edison Cube Taps
- 1 1,000W Dimmers
- 1 2,000W Dimmers

STUDIO GRIP PACKAGE

\$150.00

GRIP EQUIPMENT

- 12 Shot Bags (15 lb)
- 16 Apple Boxes (4 ea.)
- 2 Fiberglass Step Ladders (6' & 12')
- 2 10' Speedrail Pipe (1-1/4")
- 2 5' Speedrail Pipe (1-1/4")
- 3 Pipe Joiners (1-1/4")
- 10 Safety Cables/Chains
- 16 # 1 Grip Clips
- 12 # 2 Grip Clips
- 6 # 3 Grip Clips
- 1 Set Wedges (24)
- 1 Set Cribbing (24)
- 6 Furniture/Sound Blankets

BABY SIZE GRIP

- 1 Baby Triple Header
- 4 Baby Wall Plates
- 8 Baby Pipe Hangers
- 4 C-Clamps W/Baby Spud
- 4 Gator Grips W/Baby Spud
- 2 Mafer Clamps W/Baby Spud
- 4 Cardellini Clamps W/Baby Spud
- 2 Bead Board Holders
- 1 Cantrell Holder

JUNIOR GRIP

- 4 Large Jr. Grip Heads (4-1/2")
- 1 Jr. Triple Headers
- 6 Jr. Pipe Hangers
- 4 Jr. Wall Plates
- 2 C Clamps W/Jr. Receiver
- 4 Stand Adapters (1-1/8" to 5/8")
- 4 Jr. Pipe Palms
- 1 Jr. C Stand Boom Clamp

C-STANDS & FLAGS

- 10 40" C-Stands W/Heads & Arms
- 2 20" C-Stands W/Heads & Arms
- 1 Set Fingers 2" x 14", 4" x 14", 6" x 14" (9 pcs.)
- 1 Set Fingers 2" x 14", 4" x 14", 6" x 14" (9 pcs.)
- 4 18" x 24" flags
- 2 18" x 24" Silks
- 2 18" X 24" Single Nets
- 2 18" x 24" Double Nets
- 2 24" x 36" Flags
- 2 24" x 36" Silks
- 2 24" x 36" Single Nets
- 2 24" x 36" Double Nets
- 2 48" x 48" Flags (Flop Down)
- 2 24" x 36" Open Frames
- 4 48" x 48" Open Frames
- 1 C Stand/Flag Cart

STANDS

- 2 3 Riser Combo Stands (Max. Ht. 14'3")
- 7 2 Riser Combo Stands (Max. Ht. 11'3")
- 2 Low Boy Combo Stands (Min. Ht. 33")
- 8 Beefy Baby Stands (Max. Ht. 12'5")
- 2 Mini Baby Stands (Min. Ht. 22")
- 1 Floor Spider (T-Bone)

EXPENDABLES (available for purchase)

Diffusion / Color Correction

Full, 1/2, 1/4, 1/8 CTB	\$6.00 ft.
Full, 1/2, 1/4, 1/8 CTO	\$6.00 ft.
ND3, ND6, ND9	\$6.00 ft.
Full, 1/2, 1/4, 1/8 Plus Green	\$6.00 ft.
Full, 1/2, 1/4, 1/8 Minus Green	\$6.00 ft.
Opal, 216, 250, 251	\$6.00 ft.
Hampshire Frost, Lt. Grid Cloth	\$6.00 ft.
Brushed Silk, Hollywood Frost	\$6.00 ft.
Assorted Theatrical Gel Sheets	\$7.00
Roll Color Correction	\$120.00
Roll Diffusion	\$110.00

Paper Products

48" Trace Paper	\$2.00 ft
72" Trace paper	\$3.00 ft
4' x 8' White/White Foam Core	\$25.00
4' x 8' Black/White Foam Core	\$35.00
4' x 8' Black/Black Foam Core	\$30.00
Black/White Art Card	\$6.00
Silver/White Art Card	\$6.00
Gold/White Art Card	\$6.00

Rope

50' #8 Sash Cord	\$8.75
100' #8 Sash Cord	\$10.50
100' #10 Sash Cord	\$14.75
50' 1/4" Hemp Rope	\$5.25

Lumber

4' x 8' x 3/4" Plywood	\$38.50
4' x 8' x 1/8" Masonite	\$9.75
1" x 4" x 8' Lumber	\$2.75
2" x 2" x 8' Lumber	\$3.00
2" x 4" x 8' Lumber	\$4.50

Foils

12" Black Wrap (12" & 24")	\$2.00 ft
24" Black Wrap	\$4.00 ft
12" or 24" Roll Black Wrap	\$27.50
Roll Aluminum Foil	

PHOTO FLOODS

211 75W 3000 Degree K	\$4.95
212 150W 3000 Degree K	\$5.05
213 250W 3400 Degree K	\$4.95
ECT 500W 3200 Degree K	\$6.05
EAL 500W 3200 Degree K	\$16.65
BBA 250W 3400 Degree K	\$4.10
BCA 250W 4800 Degree K	\$3.50
EBW 500W 4800 Degree K	\$7.50
60W Blue	\$4.75
Household Bulbs	\$1.75

Tape

2" Gaffer Tap[e (Black, White, Grey)	\$17.95
1" Camera Tape (Black White & Misc. Colors)	\$8.95
1" Flourescent Camera Tape	\$9.95
2" Paper Tape (Black)	\$7.95
2" Paper Tape (White)	\$8.95
1" Paper Tape (Assorted Colors)	\$4.95
1" Paper Tape (Floerescent)	\$6.95
Caution Tape	\$6.95
ATG Tape	\$7.95
Scotch Double Sided Tape	\$7.25
1" J-Lar	\$9.95
2" J-Lar	\$17.95

Misc.

Can Spray Paint (Flat Black & Flat White)	Prices
Can Spray Mount	Upon
Can Dulling Spray	Request
Can Furniture Polish	
Can WD40	
Roll Paper Towels	
Bottle Armour All	
Bottle Windex	
Roll Garbage Bags	
Roll Aluminum Foil	
Can Clothes Pins	
Baby Powder	
Roll Duvetyne (54" x 50' Approx.)	\$4.00 ft
Roll Clear Plastic Sheeting	\$5.00
Roll Black Plastic Sheeting	\$5.00

LIGHTS ON NEBRASKA

Equipment in this section is priced to rent on a piece by piece basis. If your production requires a specific light or piece of equipment in addition to what you already have, we can complete your equipment needs.

Our large inventory includes Mole-Richardson, ARRI, KINO FLO, LTM, Dedo Lights, Chimera Light Banks, American, Matthews and Fisher to name a few. No matter what your requirements, you are assured well maintained, quality equipment.

For seven consecutive rental days we will discount our rental rates to equal 4 times the daily rate.

We are available to you on a 24 hour basis, for whatever reason.

ITEM PRICES (LIGHTING)

HMI LIGHTING

HMI FRESNELS (Magnetic)

*12,000W HMI Fresnel (LTM)	\$450.00
12 K Ear Extension (Set of 3)	\$20.00
*6,000W HMI Fresnel (LTM)	\$300.00
4,000W HMI Fresnel (Janiro)	\$200.00
Light Include: Head, Ballast, Head Cable, Stand, Barndoor & Scrim.	
* Stand not included.	

HMI FRESNELS (Electronic)

1,200W HMI Fresnel (ARRI)	\$125.00
575W HMI Fresnel (ARRI)	\$100.00
Light Include: Head, Ballast, Head Cable, Stand, Barndoor & Scrim.	

SQUARE WAVE BALLAST

	W/Head	W/O Head
2.5/4K 110/220V Ballast	\$85.00	\$120.00
575/1.2 110/220V Ballast	\$55.00	\$70.00

HMI EXTENSIONS

50' HMI Extension 575W-4K	\$10.00
50' HMI Extension 6K-12K	\$25.00

HMI PARS (Magnetic)

2,500W HMI Par (Sunray)	\$250.00
Light include: Head, Ballast, Head Cable, Stand, Barndoor, Lens Set & Scrim.	

HMI PARS (Electronic)

4,000W HMI Par (ARRI)	\$400.00
2,500W HMI Par (ARRI)	\$325.00
1,200W HMI Par (ARRI)	\$135.00
575W HMI Par (ARRI)	\$110.00
400W HMI Par (ARRI)	\$100.00
200W HMI Par (ARRI)	\$90.00
Light include: Head, Ballast, Head Cable, Stand, Barndoor, Lens Set & Scrim.	

HMI LIGHTING KITS

200W HMI Par Kit (ARRI)	\$110.00
400W HMI Par Kit (ARRI)	\$120.00
Kits Include: Head, Electronic Ballast, 25' Extension, Lens Set, Scrim, Barndoor, Case, Chimera Sm. Video Pro Bank W/Ring.	

KINO FLO LIGHTING

KINO FLO (Flicker Free High Output Fluor.)

Image 80 DMX (8 Bank)	\$150.00
4-Bank System (4' or 2')	\$65.00
2-Bank System (4' or 2')	\$35.00
1-Bank System (4' or 2')	\$18.00

Each system Includes Daylight or Tungsten Lamps, Ballast, 25' Extension, Mounting Plate.

EXTRA KINO FLO LAMPS

2' Lamps	\$3.50
4' Lamps	\$3.50
15" Lamps	\$2.00

KINO FLO Kit (15" Fixture)

	\$50.00
Kit Includes: Daylight or Tungsten Lamps, 1)120V AC Power Supply, 2)12' Extensions, 2)15" Fixtures, 2) Ballasts, 1)12V/DC Cigarette Adapter W/"Y" Splitter, 2)Mounting Plates, 1)12V/DC Alligator Clip W/ "Y" Splitter, & Case.	

KINO FLO Package

	\$280.00
Package Includes:	
1) 2' 4 Bank System	
2) 2' 2 Banks Systems	
2) 4' 4 Banks Systems	
2) 4' 2 Banks Systems	
With your choice of Daylight or Tungsten Lamps.	

MISC. FLUORESCENT TUBES

2' FLOURESCENTS

2' 3200 K Tube (Vita Light)	\$2.50
2' 5000 K Lamp (Chroma 50)	\$1.50
2' Cool White/Warm White	\$1.00

8' FLOURESCENTS

8' 5000 K Lamp (Chroma 50)	\$2.00
----------------------------	--------

4' FLOURESCENTS

4' 3200 K Tube (Vita Light)	\$2.50
4' 5000 K Lamp (Chroma 50)	\$1.50
4' Cool White/Warm White	\$1.00

(402) 331-4340 Fax (402) 331-4556

ITEM PRICES (LIGHTING)

TUNGSTEN LIGHTING

TUNGSTEN (FRESNELS)

*10,000W Baby Tenor Solarspot	\$120.00
*10,000 Solarspot (Ianiro)	\$110.00
5,000W Baby Senior Solarspot	\$60.00
2,000W 8" Junior Solarspot	\$35.00
1,000W Baby Solarspot	\$30.00
650W Tweenie Mole Solarspot	\$25.00
650W Fresnel (ARRI)	\$25.00
300W Fresnel (ARRI)	\$20.00
200W Midget Solarspot	\$20.00
200W Pepper Fresnel (LTM)	\$15.00
150W Fresnel (ARRI)	\$15.00

Lights Include: Head, Head Cable, Stand, Scrim Set, Spare Lamp & Barndoor.

*Stand not included.

TUNGSTEN (OPEN FACE)

2,000W Mighty Mole	\$30.00
1,000W Mickey Mole	\$25.00
2,000W Nook Light	\$25.00
1,00W Nook Light	\$15.00
1,000W Tota Light (Lowel)	\$10.00

Lights Include: Head, Head Cable, Stand, Scrim & Barndoor.

TUNGSTEN (SOFTLIGHTS)

2,000W Baby Soft Light	\$30.00
750W Baby Soft Light	\$20.00

Lights Include: Head, Head Cable, Barndoor, Eggcrate, Gel Frame & Stand.

TUNGSTEN (PARS)

24,000W Ultra Dino Light	\$315.00
9,000W Nine-Light Ultra Maxi Par Brute	\$150.00
1,000W One-Light Molepar	\$25.00
Additional 3200 K Lamps	\$5.00

TUNGSTEN (MOLEFAYS)

5,580W Nine-Light	\$85.00
-------------------	---------

TUNGSTEN (STUDIO LIGHTING)

2,000W Ultra Space Light	\$40.00
--------------------------	---------

Includes: Silk Skirt, Solid Skirt, Silk Diffusion & Safety Screen.

6,000W Ultra Space Light	\$90.00
--------------------------	---------

Includes: Silk Skirt, Solid Skirt, Silk Diffusion & Safety Screen.

LIGHTING ACCESSORIES

Barndoors (Separate)	\$4.00
Set of Scrim (Any Size)	\$2.00
Eggcrate (Separate)	\$4.00
Ring Snoot (Any Size)	\$3.00

SPECIAL LIGHTING

100W/200W Stick-Up	\$12.00
--------------------	---------

TUNGSTEN KITS

<u>150W Dedolight Kit</u>	\$125.00
---------------------------	----------

Includes: 3)150W Dedolights, 3)Extension Cables, 3)Filter Holders, 3)Barndoors, 1)Power Supply/Control Unit, 1)Vacuum Mount, 3)Stands, Case, Projection Attachment complete with 85mm Lens & built in 4-Leaf Framing "Venitian Blinds" Shutters.

<u>ARRI Combo Kit 4-Light</u>	\$75.00
-------------------------------	---------

Includes: 2) 650 Fresnels, 2) 300 Fresnels, 4) Stands 4) Scrim Sets, 4) Gel Frames, 1) 25' Stinger & Case.

4-Light Practical Kit	\$10.00
5-Light Practical Kit	\$12.50

ROCK & ROLL LIGHTING

575W Source Four Ellipsoidal	\$18.00
750W Source Four Ellipsoidal	\$20.00

W/19, 26, 36, or 50 Degree Lens, Gel Frame & Pattern Holder.

Source Four Tube Only	\$5.00
1,000W Par Can	\$18.00

CHIMERAS

CHIMERA (Quartz & HMI Soft Boxes)

XXS Video Pro (12" x 16") W/Ring	\$20.00
XS Video Pro (16" x 22") W/Ring	\$25.00
Sm. Video Pro (24" x 32") W/Ring	\$30.00
Sm. Quartz Bank (24" x 32") W/ Ring	\$45.00
Med. Quartz Bank (36" x 48") W/Ring	\$55.00
Window Pattern Kit	\$50.00

ACCESSORIES

Fabric Grids (Any Size)	\$10.00
Extra Ring (Any Size)	\$10.00
Ring Only (W/O Bank)	\$15.00

(402) 331-4340 Fax (402) 331-4556

ITEM PRICES (GRIP)

STANDS

Cinevator (Max. Ht. 11'7")	\$55.00
Super Crank-O-Vator (Max. Ht. 11'7")	\$50.00
Mombo Combo (Max. Ht. 23'5")	\$18.00
3-Riser Hi-Walker W/Fathead (Max. Ht. 19')	\$12.00
3-Riser Combo Stand (Max. Ht. 14'3")	\$5.00
2-Riser Combo stand (Max. Ht. 11'3")	\$4.00
Low Boy Combo Stand (Min. Ht. 33")	\$3.00
Beefy Baby Stand (Max. Ht. 12'5")	\$3.00
Mini Baby Stand (Min. Ht. 22")	\$3.00
Turtle Stand	\$3.50
Floor Spider	\$5.00
Set Cup Blocks (16)	\$3.00
Set Mombo Wheels	\$5.00
Set Combo Wheels	\$3.00
Set Baby Wheels	\$3.00

C STANDS & FLAGS

20" C Stand W/Head & Arm	\$3.00
20" C Stand W/Head & Arm (Mini Base)	\$3.00
40" C Stand W/Head & Arm	\$4.50
40" C Stand W/Head & Arm (Turtle Base)	\$4.50
C Stand Arm	\$2.00
Small Grip Head (2-1/2")	\$2.00
Small Double Grip Head (4-1/2")	\$3.00
Large Jr. Grip Head (4-1/2")	\$3.00
Set of Fingers (Set of 18)	\$20.00
Set of Dots (Set of 18)	\$20.00
Flags (Assorted)	\$3.00
Sizes: 10" x 12", 12" x 18", 18" x 24", 24" x 36"	
Silks (Assorted Sizes)	\$3.50
12" x 18", 18" x 24", 24" x 36"	
Nets: Single or Double (Assorted Sizes)	\$3.50
10" x 12", 12" x 18", 18" x 24", 24" x 36"	
10" x 42" Cutter	\$4.00
18" x 42" Cutter	\$5.00
24" x 72" Cutter	\$6.00
48" x 48" Cutter	\$6.00
48" x 48" Cutter (Flop Down)	\$8.00
48" x 48" Silk	\$10.00
24" x 36" Wood Cucoloris	\$3.00
48" x 48" Wood Cucoloris	\$5.00
18" x 24" Celo Cucaloris	\$3.00
24" x 36" Celo Cucoloris	\$4.00
48" x 48" Celo Cucoliris	\$5.00
Open Frames (Assorted Sizes)	\$2.50
24" x 24", 24" x 36", 48" x 48"	
C Stand Flag Cart	\$25.00

JUNIOR GRIP

Large Jr, Grip Head (4-1/2")	\$3.00
Jr. Triple Header	\$3.00
Jr. Stand Extension (36")	\$2.00
Jr. Wall Plate	\$2.00
Jr. Side Arm	\$2.00
Jr. Extendable Offset Arm	\$3.00
Jr. Grip Saver	\$3.00
Jr. Pipe Hanger	\$2.00
C Clamp W/Jr. Receiver (6", 8", 10", 12")	\$2.00
Stand Adapter (1-1/8" to 5/8")	\$2.00
Scaffold Clamp W/Ear	\$2.00
Tubing Clamp W/Ear	\$2.00
Jr. Spud to Pipe Hanger	\$2.00
Jr. Pipe Palm	\$2.00
Scaffold Clamp W/Jr. Receiver	\$2.00
Jr. C Stand Boom Clamp	\$3.00
Jr. Trapeze	\$3.00
Stand Adapter (1-1/8" to 5/8")	\$2.00

BABY GRIP

Baby Triple Header	\$2.00
Baby Stand Extension	\$2.00
Baby Wall Plate	\$1.50
Baby Pipe Hanger	\$2.00
C Clamp W/Baby Spud	\$2.00
Baby Right Angle Adapter	\$2.00
Baby Right Angle Plate	\$1.50
Baby Bar Clamp Adapter	\$1.50
Baby Pipe Clamp Adapter	\$1.50
1 By Holder (Baby)	\$1.50
Cantrell Holder	\$1.50
Bead Board Holder	\$2.00
Foam Core Holder	\$2.00
Furniture Clamp	\$2.00
Baby Gator Grip	\$2.00
Mafer Clamp	\$2.00
T.D. Clamp W/Baby Spud	\$2.00
Cardellini Clamp W/Baby Spud	\$3.00
Vise Grip W/Baby Spud	\$2.00
Ceiling Scissor Clip W/Baby Spud	\$1.50
TVMP Adapter (Jr. or Baby)	\$2.00

GRIP

Shot Bag (15 lb)	\$3.00
Sand Bag (35 lb)	\$5.00
Apple Box (Any Size)	\$2.00
Basso Blocks (12) (10"x6"x4-1/2")	\$10.00
Basso Blocks (24) (10"x6"x2-1/2")	\$20.00

ITEM PRICES (GRIP/SUPPORT)

GRIP cont.

Stair Blocks (4)	\$6.00	# 1 Grip Clips (String of 40)	\$8.00
2" x 4" Wall Spreader (W/Tube Stretche	\$5.00	# 2 Grip Clips (String of 12)	\$5.00
Telescoping Hanger (3' to 6')	\$3.00	# 3 Grip Clips (String of 8)	\$3.00
C Clamps (Assorted Sizes)	\$0.50	Ratchet Strap	\$2.50
1", 2", 3", 4", 6" and 8"		Traffic Cone	\$1.00
4" C Clamp Tree Branch Holder W/Ear	\$3.00	Tent Stake	\$1.50
20' Speedrail Tubing (1-1/4")	\$5.00	Tent Stake (24" Heavy Duty)	\$4.00
10' or 5' Speedrail Tubing (1-1/4")	\$2.00	Cup Blocks (Set of 16)	\$3.00
1-1/4" Speedrail Tubing (Misc. Lengths)	\$1.50	Wedges or Cribbing (Crate of 14)	\$2.00
Pipe Joiner (1-1/4")	\$2.00	4' Level	\$3.00
Pipe Bridge Joiner (1-1/4")	\$3.00	Furniture/Sound Blanket	\$1.50
1-1/4" Speedrail Fittings	\$2.00	Rubber Floor Runner	\$2.25
Cheeseboro Swivel Pipe Clamp	\$1.50	Cable Cart	\$20.00
Safety Chain/Cable (36")	\$0.75	Grip/Electric Cart	\$25.00
Safety Chain/Cable (String of 10)	\$5.00	Magliner (2/4 Wheel Hand Cart)	\$10.00

SUPPORT (Stands Not Included)

<u>20' x 20' OVERHEAD SET</u>	\$140.00	<u>8' x 8' OVERHEADS</u>	
Includes: Silk, Solid, Griff & Frame		8' x 8' Frame	\$15.00
20' x 20' Frame	\$40.00	8' x 8' Silk	\$15.00
20' x 20' Silk	\$40.00	8' x 8' Black Silk	\$15.00
20' x 20' Solid	\$40.00	8' x 8' Solid	\$15.00
20' x 20' Griffolyn (Black/White)	\$40.00	8' x 8' Griffolyn	\$15.00
20' x 20' 1/4 Stop Silk (White)	\$50.00	8' x 8' 1/4 Stop Silk (White)	\$20.00
20' x 20' Light Grid Cloth (Rip Stop)	\$50.00	8' x 8' Single White Net	\$20.00
20' x 20' Blue Screen	\$95.00	8' x 8' Double White Net	\$20.00
20' x 20' Green Screen	\$95.00	8' x 8' Silver/White Reflective (Priscilla)	\$20.00
		8' x 8' Light Grid Cloth (Ripstop)	\$20.00
<u>12' x 12' OVERHEAD SET</u>	\$110.00	8' x 8' Green Screen	\$28.00
Includes: Silk, Solid, Griff, Single, Double & Frame		8' x 8' Checkerboard (Lisa Marie)	\$20.00
12' x 12' Frame	\$20.00		
12' x 12' Silk	\$20.00	<u>6' x 6' BUTTERFLY SET</u>	\$85.00
12' x 12' Solid	\$20.00	Includes: Silk, Solid, Griff, Single, Double & Frame	
12' x 12' Griffolyn	\$20.00	6' x 6' Frame	\$12.50
12' x 12' Single Net	\$20.00	6' x 6' Silk	\$12.50
12' x 12' Double Net	\$20.00	6' x 6' Solid	\$12.50
12' x 12' 1/4 Stop Silk (White)	\$25.00	6' x 6' Griffolyn	\$12.50
12' x 12' Single White Net	\$25.00	6' x 6' 1/4 Stop Silk (White)	\$15.00
12' x 12' Double White Net	\$25.00	6' x 6' Single Net	\$12.50
12' x 12' Muslin (Bleached)	\$25.00	6' x 6' Double Net	\$12.50
12' x 12' Gold/White Reflective (Elvis)	\$25.00	6' x 6' Gold/White Reflective (Elvis)	\$15.00
12' x 12' Silver/Gold Reflective (Priscilla)	\$25.00	6' x 6' Silver/White Reflective (Priscilla)	\$15.00
12' x 12' Checkerboard (Lisa Marie)	\$25.00	6' x 6' Light Grid Cloth (Ripstop)	\$15.00
12' x 12' Light Grid Cloth (Ripstop)	\$25.00	6' x 6' Blue Screen	\$20.00
12' x 12' Full Grid Cloth (Ripstop)	\$25.00	<u>REFLECTORS</u>	
12' x 12' Blue Screen	\$45.00	42" x 42" Silver Reflector W/Stand	\$25.00
12' x 12' Green Screen	\$45.00	42" x 42" Rifle W/Stand	\$35.00
12' x 12' Ultrabounce	\$25.00		
12' x 12' 1/2 Soft Frost	\$25.00		

ITEM PRICES (SUPPORT / ELECTRICAL)

MISCELLANEOUS SUPPORT

Director's Chair (High)	\$8.00
6' Folding Tables	\$6.00
8' Folding Tables	\$8.00
Megaphone	\$10.00
Cooler	\$3.00

LADDERS

4' Fiberglass Double Step Ladder	\$6.00
6' Fiberglass Double Step Ladder	\$8.00
10' Fiberglass Double Step Ladder	\$12.00
Little Giant (19' Extended/9' Step Ladder)	\$10.00
10' Aluminum Step Ladder	\$7.00

ELECTRICAL

TIE-INS (Camlok)

8' 2/0 5-Wire Clips to Female Camlok	\$20.00
8' 2/0 4-Wire Clips to Female Camlok	\$17.50
8' 2/0 3-Wire Clips to Female Camlok	\$15.00
8' 2/0 or #2 5-Wire Bare End to Female Camlok	\$15.00
8' 2/0 or #2 4-Wire Bare End to Female Camlok	\$12.50
8' 2/0 or #2 3-Wire Bare End to Female Camlok	\$10.00
8' Range Plug to Female Camlok	\$10.00

DISTRIBUTION BOXES

600A 3-Phase Camlok Thru Box (120V)	\$65.00
400A Single-Phase Camlok Thru Box (120V)	\$55.00
100A Bates to 5-20A Edisons (Circuit Breaker)	\$12.00
100A Bates Pass Thru 5-20A Edisons (Circuit Breaker)	\$15.00
60A Bates to 3-Duplex 20A Edisons (Circuit Breaker)	\$10.00

ADAPTERS

Camlok Tapping T or Paralleling T (2-Fers)	\$2.00
Camlok 3-Fers	\$5.00
Male/Male Camlok Turnaround	\$2.00
Female/Female Camlok Turnaround	\$2.00
100A Bates to 2-60A Fused Female Bates	\$6.00
60 Amp Bates to 2-60 Amp Female Bates	\$6.00
Male Camlok to 2-100 Amp Female Bates	\$9.00
Male Camlok to 1-100A Fused Female Bates	\$6.00
Male Camlok to 1-60A Fused Female Bates	\$6.00
Male Camlok to 1-100A Fused Female Bates (200V)	\$6.00
25' 100 Amp Male Bates to Mole 2-Pocket	\$6.00
100A Full Stage Plug to 100A Female Bates	\$2.00
100A Full Stage Plug to 60 Amp Female Bates	\$2.00
20A Male Bates to Female Edison (Adapter)	\$1.50
20A Female Bates to Male Edison (Adapter)	\$1.50
Edison Cube Tap	\$1.00
Camlok Six Hole Box	\$5.00
Paddle - Half Stage to Edison	\$2.00
Paddle - Full Stage to Edison	\$3.00

EXTENSION CABLES (Edison)

25' A/C Edison Extension (12/3 Cable)	\$2.00
50' A/C Edison Extension (12/3 Cable)	\$2.75
75' A/C Edison Extension (12/3 Cable)	\$3.50

EXTENSION CABLES (Bates)

50' 100 Amp Bates Extension Cable	\$9.00
25' 100 Amp Bates Extension Cable	\$7.00
50' 60 Amp Bates Extension Cable	\$7.00
25' 60 Amp Bates Extension Cable	\$6.00

FEEDER CABLE

50' 2/0 Single Strand Camlok	\$8.00
50' #2 Single Strand Camlok (Ground)	\$5.00
50' #2 4-Wire Banded Camlok Feeder	\$15.00
50' #2 5-Wire Banded Camlok Feeder	\$20.00

DISCONNECTS

350 Amp Camlok Bull Switch	\$30.00
----------------------------	---------

DIMMING & CONTROL DEVICES

1,000W Dimmer	\$8.00
2,000W Dimmer	\$12.00
1,000W Variac	\$15.00
2,000W Variac	\$20.00
1,000W AC Inverter	\$50.00
7,200W Shadow Maker (3-Channel Flicker Generator/Dimmer)	\$65.00

MISCELLANEOUS ELECTRIC

Cable Ramp 3' 5 Conductor "	\$20.00
"Yellow Jacket"	
Cable/Sandbag Cart	\$20.00

6500W 120V AC GENERATOR \$135.00

Honda - Non-Crystal 120V/240V (54.2/27.1A) Non-Crystal	
---	--

CAMERA DOLLY PRICES

LIGHTS ON NEBRASKA offers the **Fisher Model 11 Camera Dolly**, the smallest Fisher Dolly. Lightweight and compact, it's built with the same high quality standards found in all J.L. Fisher products. The **Model 11 Dolly** shares the same controls and characteristics of the Model 10 Dolly and has a complete line of its own accessories. It operates effortlessly on square or round track.

The **Model 11 Dolly** is engineered and manufactured to meet the demanding production needs of the motion picture, television and video industries. Its compact size, three-way steering and a solid lift beam give operators a wide variety of options. It's reliable, quiet, smooth and safe.

FISHER MODEL 11 DOLLY \$225.00

- 1 - Standard Level Head
- 1 - Low Level Head
- 2 - Camera Dolly Seats
- 1 - 6" Dolly Seat Riser
- 1 - Seat Offset High
- 2 - 12" Dolly Camera Risers
- 1 - 24" Camera Offset
- 2 - High Boards
- 2 - Low Boards
- 2 - Front Boards
- 2 - Diving Boards
- 1 - Battery Rack
- 1 - Track Ramp

MODEL 11 SPECIFICATIONS

- 51-1/2" Maximum Lift Beam Elevation
- 15-1/2" Minimum Elevation (Level Head Down)
- 3-5/8" Minimum Elevation (Low Level Head)
- 34" Vertical Beam Travel
- 200 lbs Lift Capacity
- 6 Lifts Per System Charge
- 39-5.8" Length (Level Head Reversed)
- 25-3/4" Width (Wheels Out)
- 16-3/16" Minimum Turning Radius (Round Steering)
- 33-1.2" Minimum Turn Radius (Conventional Steering)

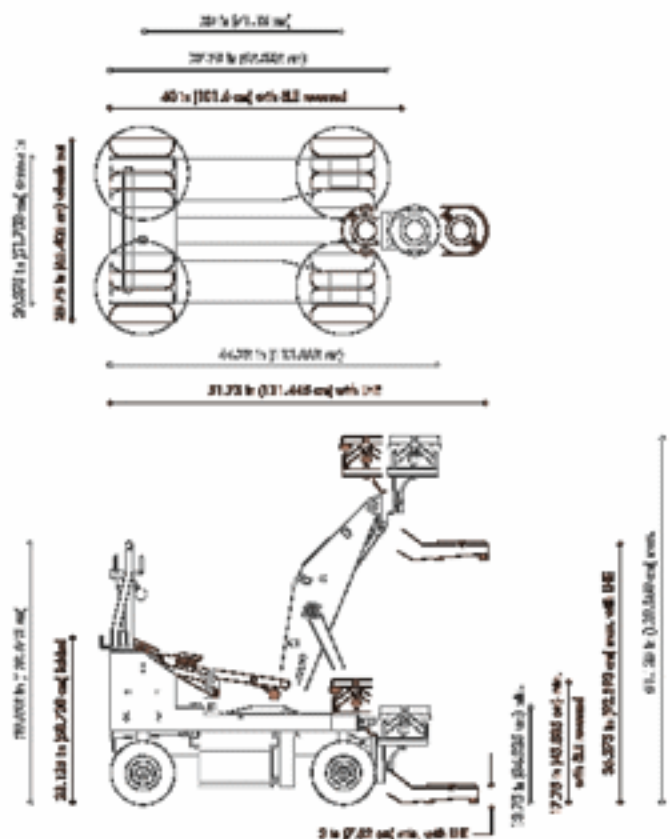

CAMERA DOLLIES / JIB ARMS

AMERICAN DOORWAY DOLLY

\$50.00

Includes: Dolly, Track Wheel Set, Side Boards,
Push-Pull Bar, Steering Bar

DOLLY TRACK

Starter Tube Track	\$5.00
4' Straight Tube or Square Track	\$10.00
8' Straight Tube or Square Track	\$12.00
Curved Track (45 Degree)	\$15.00
20' Diameter Curve / 8 Pieces = Circle	
Curved Track (90 Degree)	\$25.00
10' Diameter Curve / 4 Pieces = Circle	
Skateboard Wheel Set (32 Channel)	\$50.00
4' Level	\$3.00

DOLLY ACCESSORIES

Rotating Offset	\$35.00
12" Dolly Riser	\$8.00
24" Extension	\$8.00
Dolly Seat	\$5.30
12" Seat Riser	\$3.00
Offset Arm	\$8.00

CAMERA SUPPORT

Standard Sticks	\$25.00
Hi-Hat	\$10.00
Spreader	\$5.00
Mitchell to Sacthlet Adapter	\$5.00

CAR MOUNT

Hostess Tray	\$65.00
--------------	---------

JIB ARMS

TRAVATO TOTE JIB ARM (Model 48)

\$125.00

It's quickly and easily set up.
Receiver Head inverts for (underslung) operation.
Reach of 58 inches and a vertical travel of 68 inches.
Holds a payload of over 50 lbs.
Standard barbell weights (included) are easily
moved to precisely balance the camera.
It' easily stored and weights only 30 lbs.

150mm Bowl to Mitchell Adapter & Sticks \$50.00

TRAVATO QUATRO 72 JIB ARM

\$150.00

Receiver head inverts for underslung operation.
Accepts Mitchell receiver head.
18" offset plate to raise or lower camera.
7' reach with 102" vertical travel.
Quick and easy set up.

BARBELL WEIGHTS (W/O JIB ARM)

50 lb Weight (w/o Jib)	\$5.00
25 lb Weight (w/o Jib)	\$2.50
10 lb Weight (w/o Jib)	\$1.00
5 lb Weight (w/o Jib)	\$0.50
2.5 lb Weight (w/o Jib)	\$0.25

Studio Base for Jib Arm \$150.00

www.lightsonrentals.com

(402) 331-4340 Fax (402) 331-4556